

UNITY LAUNDRY SYSTEMS MODEL UTS29B

ON-PREMISE LAUNDRY
HIGH EFFICIENCY SOFT MOUNT
WASHER EXTRACTOR

Easy To Use Controls
with an intuitive design and
multi-lingual support

Convenient Manual Dispenser
with an easy to flush design and four compartments: pre-
wash and main wash (powder or liquid), bleach and fabric
softener (liquid only)

**5 Chemical Injection
Ports**
for compatibility with
any external
automatic chemical
dosing system

Emergency Stop
for operator safety

**Perfectly Tuned
Extract Performance**
with optimally
designed RPMs and
G-forces to achieve
max extraction and to
prevent unbalanced
loads

Built For A Long Life
including a stainless-steel
drum and tub, high quality
bearings, and a durable
motor

Easy Installation
No concrete pad
required - just drop in
place

Easy Access Front Panel
for front servicing of the drain and
other key components

Before We Ship
we perform a double quality
check to ensure that each
washer is perfect right out of
the box



**UNITY
LAUNDRY
SYSTEMS**

— CARE BEYOND CLOTHES —

®/™ ©2022 Unity Laundry Systems. All rights reserved.

| | |
|---|--------------|
| MOTOR | |
| Size – HP (KW) | 0.5 (0.37) |
| CAPACITY | |
| Cylinder Volume – cu. ft. (liters) | 3.8 (110) |
| Cylinder Diameter – in. (mm) | 22.5 (571.5) |
| Cylinder Depth – in. (mm) | 16.3 (415) |
| Dry Load Capacity – lb. (kg) | 29.0 (13) |
| OPERATING SPEED & EXTRACT FORCE | |
| Washing Speed (RPM) | 45-48 |
| Maximum Extract Force (G-force) | 204 |
| Maximum Extract Speed (RPM) | 800 |
| CONNECTIVITY | |
| USB Programmability | Yes |
| DIMENSIONS | |
| Depth – in. (mm) | 32.6 (830) |
| Width – in. (mm) | 31.5 (800) |
| Height – in. (mm) | 46.6 (1,184) |
| CRATED DIMENSIONS | |
| Width – in. (mm) | 35 (889) |
| Depth – in. (mm) | 38 (965) |
| Height – in. (mm) | 57.5 (1,460) |
| APPROXIMATE WEIGHT | |
| Uncrated – lb. (kg) | 529.1 (240) |
| Crated – lb. (kg) | 573.2 (260) |
| ELECTRICAL CONNECTION OPTIONS (VOLTS/Hz/PHASE) | |
| 208 – 240V / 50 – 60HZ / 1PH (no electrical heating) | Yes |
| WATER HEATING OPTIONS | |
| Hot / Cold Water | Yes |
| WATER, CHEMICAL DISPENSING, DRAINS | |
| Number of Water Inlets | 3 |
| Inlet Sizes – in. (mm) | 3/4 (19.0) |
| Manual Dispenser Compartments, Number | 4 |
| External Chemical Connections, Number | 5 |
| Dump Valve Drain Size – in. (mm) | 2 (51) |
| INSTALLATION RECOMMENDATIONS | |
| Recommended Clearance Between Machines - in (mm) | 1.5 (40) |
| Recommended Clearance in front of Machines - in (mm) | 39.4 (1000) |
| Recommended Clearance Behind Machines - in (mm) | 31.5 (800) |

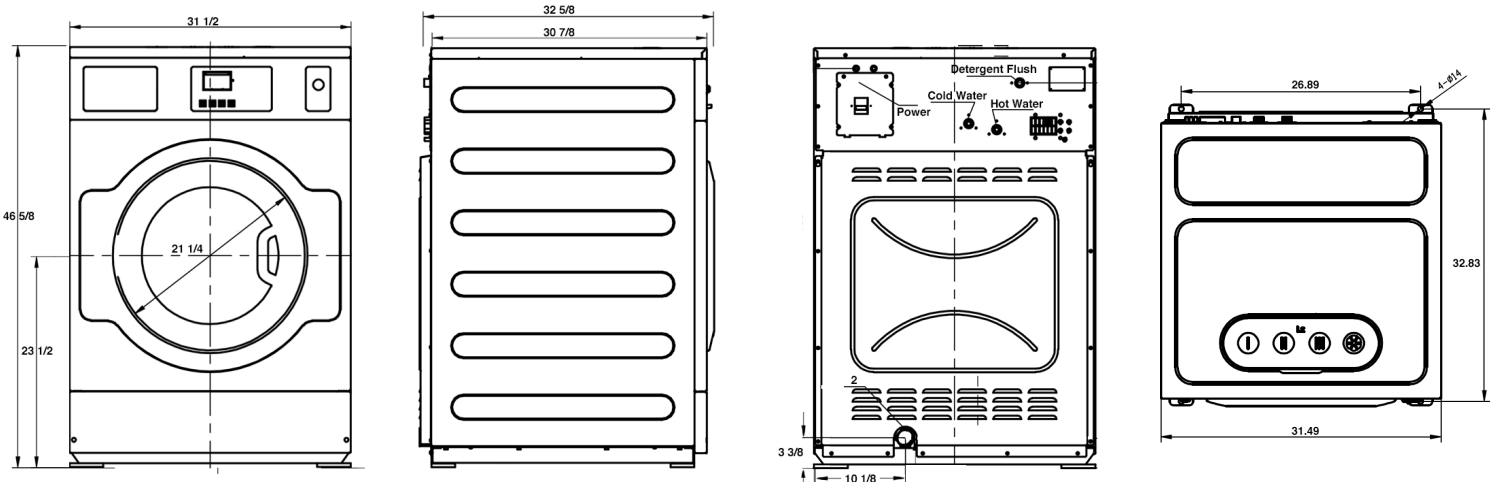
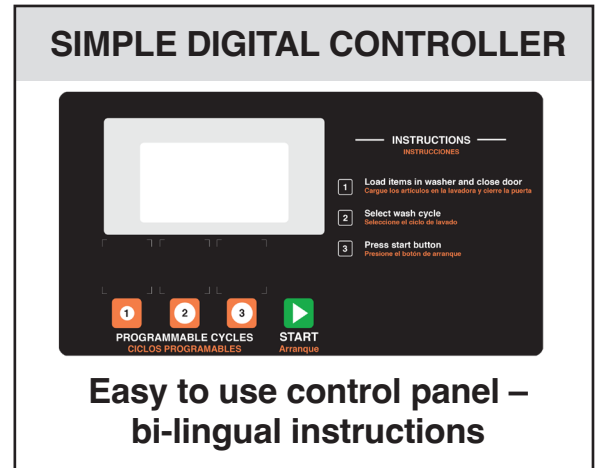
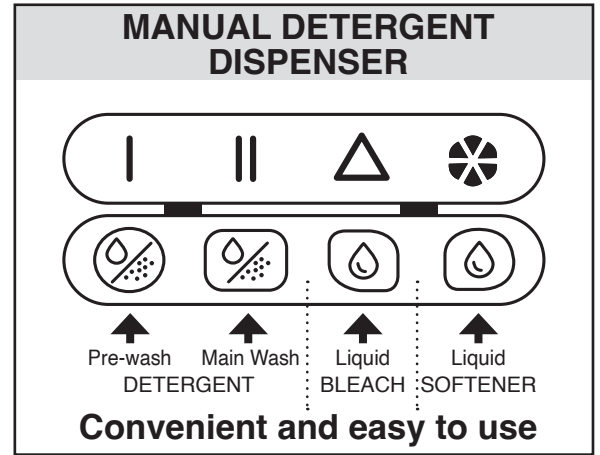

See specific instructions for proper installation. Because of continuous product improvement, Unity Laundry Systems reserves the right to change specifications without notice.

©/™ ©2022 Unity Laundry Systems. All rights reserved.



— CARE BEYOND CLOTHES —